



**MANDRINI
ATTACCO MAS403/BT
E DOPPIO CONTATTO**

TOOLHOLDERS BT/MAS403
AND DUAL DRIVE

6A



MANDRINI ATTACCO MAS403/BT E DOPPIO CONTATTO

TOOLHOLDERS BT/MAS403 AND DUAL DRIVE



MANDRINI A CAMBIO RAPIDO
QUICK CHANGE TOOLHOLDERS



MANDRINI A CAMBIO RAPIDO PASSAGGIO DEL REFRIGERANTE
COOLANT QUICK CHANGE TOOLHOLDERS

6A

Tabella tecnica

Data sheet

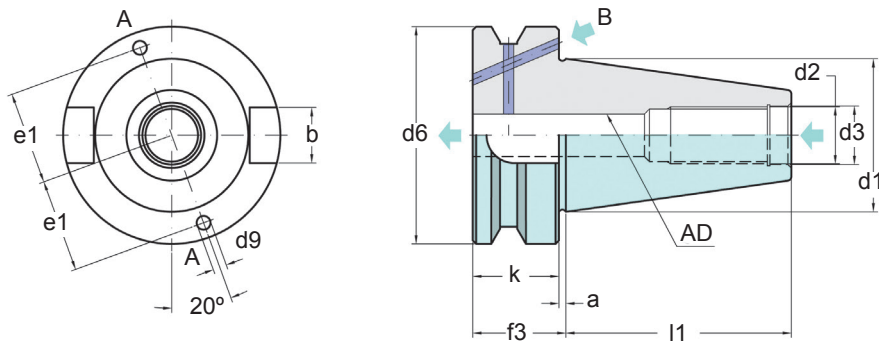

CONO TAPER	FORMA FORM	d1	d2	d3	d6	l1	a	k	f3	b	d9	e1
BT30	AD	31.75	M12	12.5	46	48.4	2	20	22	16.1	-	-
BT40	AD+B	44.45	M16	17	63	65.4	2	25	27	16.1	4	27
BT50	AD+B	69.85	M24	25	100	101.8	3	35	38	25.7	6	42

Tabella tecnica Passaggio del refrigerante

Technical table coolant thru

	SENZA PASSAGGIO DEL REFRIGERANTE WITHOUT COOLANT THRU	A
	PASSAGGIO DEL REFRIGERANTE CENTRALE COOLANT FROM CENTRE	AD
	PASSAGGIO DEL REFRIGERANTE DALLA FLANGIA COOLANT FROM FLANGE	B
	PASSAGGIO DEL REFRIGERANTE CENTRALE O DALLA FLANGIA COOLANT FROM CENTRE OR FLANGE	AD+B

I mandrini in forma AD+B possono essere usati per il passaggio del refrigerante dalla flangia e il passaggio del refrigerante dal canale centrale.

Nel sistema "TIPO 1" la regolazione avviene chiudendo il grano.

Nel sistema "TIPO 2" la regolazione avviene rimuovendo il grano.

Toolholders AD+B can be used with coolant thru "V" flange and with coolant thru centre.

"TIPO 1" system works closing the screw.

"TIPO 2" system works removing the screw.

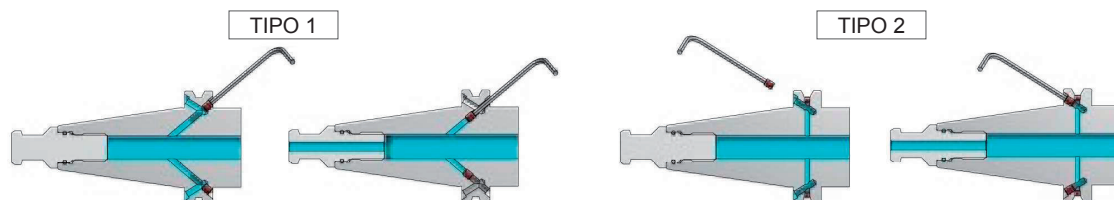

CONO	TIPO 1	TIPO 2
40	M5	M4
50	M6	M5

Mandrini con compressione e trazione

Tension and compression tapholders

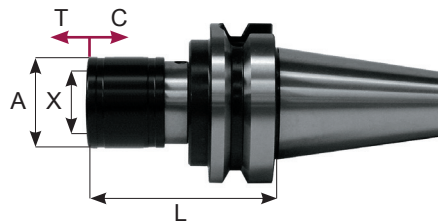
BT30 / 40 / 50

CODICE	CAP	X	A	L	T	C	EUR
BT30-THTC0-L72	M1 ÷ M10	13	26	72	6.5	6.5	
BT40-THTC0-L74				74			
BT50-THTC0-L81				81			
BT30-THTC1-L61	M3 ÷ M12	19	36	61	7.5	7.5	
BT40-THTC1-L67				67			
BT50-THTC1-L77				77			
BT40-THTC2-L94	M8 ÷ M20	31	53	94	12.5	12.5	
BT50-THTC2-L101				101			
BT40-THTC3-L164	M14 ÷ M33	48	78	164	20	20	
BT50-THTC3-L141				141			
BT40-THTC4-L164	M22 ÷ M48	60	96	164	22.5	22.5	
BT50-THTC4-L161				161			

Mandrini con solo trazione

Tension tapholders

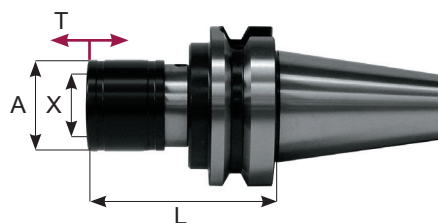
BT30 / 40 / 50

CODICE	CAP	X	A	L	T	C	EUR
BT30-THT0-L72	M1 ÷ M10	13	26	72	6.5	0	
BT40-THT0-L74				74			
BT50-THT0-L81				81			
BT30-THT1-L61	M3 ÷ M12	19	36	61	7.5	0	
BT40-THT1-L67				67			
BT50-THT1-L77				77			
BT40-THT2-L94	M8 ÷ M20	31	53	94	12.5	0	
BT50-THT2-L101				101			
BT40-THT3-L164	M14 ÷ M33	48	78	164	20	0	
BT50-THT3-L141				141			
BT40-THT4-L164	M22 ÷ M48	60	96	164	22.5	0	
BT50-THT4-L161				161			

Mandrini con compressione e trazione con passaggio del refrigerante

Coolant thru tension/compression tapholders

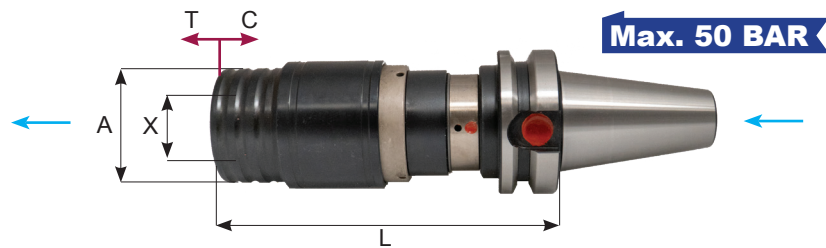
BT40 / 50

CODICE	CAP	X	A	L	T	C	EUR
BT40-THTC1-L101C	M3 ÷ M12	19	40	101	7	3	
BT50-THTC1-L110C				110			
BT40-THTC2-L137C	M8 ÷ M20	31	53	137	10	5	
BT50-THTC2-L146C				146			
BT40-THTC3-L232C	M14 ÷ M33	48	78	232	18	13	
BT50-THTC3-L211C				211			

Mandrini con compressione e trazione MAS/403BT - GC

Tension and compression tapholders MAS/403BT - GC

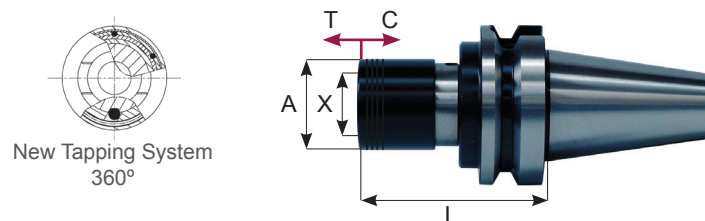
BT40 / 50

CODICE	CAP	X	A	L	T	C	EUR
BT40-GCTC1-L80	M3 ÷ M12	19	39	80	7.5	7.5	
BT50-GCTC1-L89				89			
BT40-GCT1-L72.5	M3 ÷ M12	19	39	72.5	12.5	0	
BT50-GCT1-L81.5				81.5			
BT40-GCTC2-L103	M8 ÷ M20	31	60	103	10	10	
BT50-GCTC2-L112				112			
BT40-GCT2-L93	M8 ÷ M20	31	60	93	16.5	0	
BT50-GCT2-L102				102			
BT50-GCTC3-L143	M14 ÷ M33	48	86	143	17.5	17.5	
BT50-GCT3-L125.5	M14 ÷ M33	48	86	125.5	35	0	

BT45 (Su richiesta)

Disponibile anche solo trazione / Also available only tension