



**MANDRINI ATTACCO
WELDON DIN 1835
CILINDRICO - VDI DIN 69880**

WELDON DIN 1835
CYLINDRICAL - VDI DIN 69880
TOOLHOLDERS

2F



MANDRINI ATTACCO WELDON DIN 1835 CILINDRICO - VDI DIN 69880

WELDON DIN 1835 CYLINDRICAL -
VDI DIN 69880 TOOLHOLDERS



MANDRINI PORTABROCCE
BROACH TOOLHOLDERS

2F

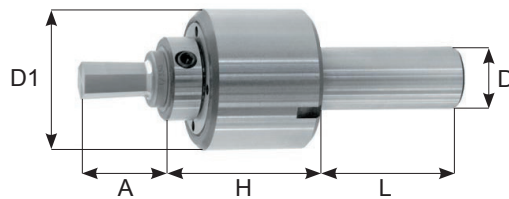
Mandrini portabrocce cilindrici
 Rotating broach toolholder

CILINDRICO

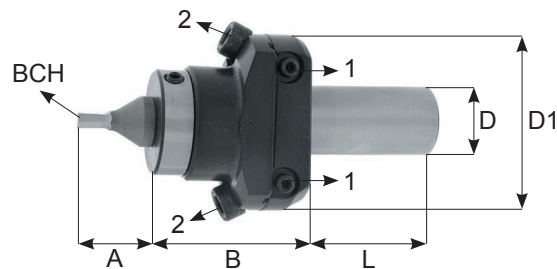
CODICE	FAM	D	H	L	D1	A	BCH	EUR
D8.L35.BCH5	1	8	34	35	22	10	5	
D10.L35.BCH5		10	34	35	22	10	5	
D12.L35.BCH5		12	34	35	22	10	5	
D16.L35.BCH5		16	34	35	22	10	5	
D20.L46.BCH5		20	34	46	22	10	5	
D10.L35.BCH8		10	38	35	32	18	8	
D12.L35.BCH8		12	38	35	32	18	8	
D16.L35.BCH8		16	38	35	32	18	8	
D20.L50.BCH8		20	38	50	32	18	8	
D25.L50.BCH8		25	38	50	32	18	8	
D16.L50.BCH12		16	46	50	44	25	12	
D20.L50.BCH12		20	46	50	44	25	12	
D25.L50.BCH12		25	46	50	44	25	12	
D32.L50.BCH12		32	46	50	44	25	12	
D20.L50.BCH16		20	76	50	58	40	16	
D25.L50.BCH16		25	76	50	58	40	16	
D32.L50.BCH16		32	76	50	58	40	16	
D40.L80.BCH16		40	76	80	58	40	16	

Mandrini portabrocce cilindrici regolabili
 Adjustable broach toolholder

CILINDRICO

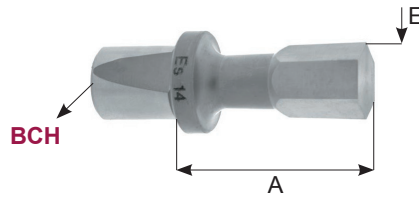
CODICE	FAM	D	B	L	D1	A	BCH	EUR
D10.L35.BCH8R	1	10	34	35	50	18	8	
D12.L35.BCH8R		12	34	35	50	18	8	
D16.L35.BCH8R		16	34	35	50	18	8	
D20.L46.BCH8R		20	34	46	50	18	8	
D25.L46.BCH8R		25	34	46	50	18	8	
D20.L50.BCH12R		20	52	50	62	25	12	
D25.L50.BCH12R		25	52	50	62	25	12	
D32.L50.BCH12R		32	52	50	62	25	12	

Brocche esagonali
Exagonal broach



BCH5

CODICE	FAM	A	EUR
BCH5.E1.5	1	10	
BCH5.E2		10	
BCH5.E2.5		10	
BCH5.E3		10	
BCH5.E3.5		10	
BCH5.E4		10	
BCH5.E5		10	
BCH5.E5.5		10	
BCH5.E6		10	

BCH8

CODICE	FAM	A	EUR
BCH8.E1.5	1	18	
BCH8.E2		18	
BCH8.E2.5		18	
BCH8.E3		18	
BCH8.E3.5		18	
BCH8.E4		18	
BCH8.E5		18	
BCH8.E5.5		18	
BCH8.E6		18	
BCH8.E7		18	
BCH8.E8	18		

BCH12

CODICE	FAM	A	EUR
BCH12.E1.5	1	25	
BCH12.E2		25	
BCH12.E2.5		25	
BCH12.E3		25	
BCH12.E3.5		25	
BCH12.E4		25	
BCH12.E5		25	
BCH12.E5.5		25	
BCH12.E6		25	
BCH12.E7		25	
BCH12.E8		25	
BCH12.E9		25	
BCH12.E10		25	
BCH12.E11		25	
BCH12.E12	25		
BCH12.E13	25		
BCH12.E14	25		

BCH16

CODICE	FAM	A	EUR
BCH16.E3	1	40	
BCH16.E3.5		40	
BCH16.E4		40	
BCH16.E5		40	
BCH16.E6		40	
BCH16.E7		40	
BCH16.E8		40	
BCH16.E9		40	
BCH16.E10		40	
BCH16.E11		40	
BCH16.E12		40	
BCH16.E13		40	
BCH16.E14		40	
BCH16.E15		40	
BCH16.E16		40	
BCH16.E17		40	
BCH16.E18		40	
BCH16.E19		40	
BCH16.E20		40	
BCH16.E21		40	
BCH16.E22		40	
BCH16.E23		40	
BCH16.E24		40	
BCH16.E25		40	

Brocche quadre
Square broach

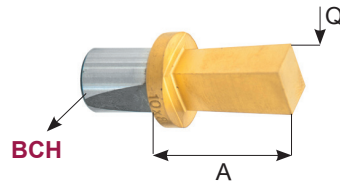

BCH5

CODICE	FAM	A	EUR
BCH5.Q3	1	10	
BCH5.Q4		10	
BCH5.Q5		10	
BCH5.Q6		10	

BCH8

CODICE	FAM	A	EUR
BCH8.Q2	1	18	
BCH8.Q3		18	
BCH8.Q4		18	
BCH8.Q5		18	
BCH8.Q5.5		18	
BCH8.Q6		18	
BCH8.Q7		18	

BCH12

CODICE	FAM	A	EUR
BCH12.Q3	1	25	
BCH12.Q4		25	
BCH12.Q5		25	
BCH12.Q5.5		25	
BCH12.Q6		25	
BCH12.Q7		25	
BCH12.Q8		25	
BCH12.Q9		25	
BCH12.Q10		25	
BCH12.Q11		25	
BCH12.Q12		25	

BCH16

CODICE	FAM	A	EUR
BCH16.Q4	1	40	
BCH16.Q5		40	
BCH16.Q6		40	
BCH16.Q7		40	
BCH16.Q8		40	
BCH16.Q9		40	
BCH16.Q10		40	
BCH16.Q11		40	
BCH16.Q12		40	
BCH16.Q13		40	
BCH16.Q14		40	
BCH16.Q15		40	
BCH16.Q16		40	
BCH16.Q17		40	
BCH16.Q18		40	
BCH16.Q20		40	

BROCCHE TORX CONTATTA IL COMMERCIALE PER MAGGIORI DETTAGLI
BROACH TORX CALL YOUR DEALER FOR MORE DETAILS

Portabarra regolabile cilindrico con compensazione

Damped rotary adjustable bar-stop

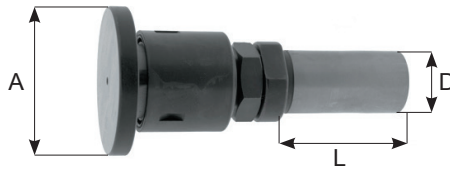

CILINDRICO

CODICE	FAM	D	L	A	EUR
D25.SAS.56	1	25	50	56	
D32.SAS.56		32	50	56	

Portapinze con flangia

Flange er collet holder

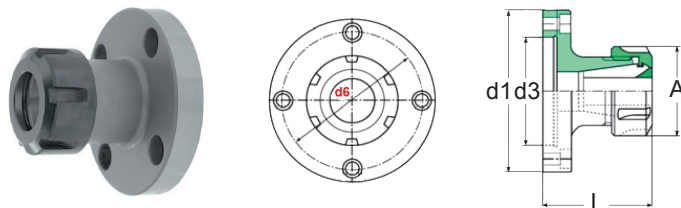

FLANGE

CODICE	FAM	A	d1	d3	d6	L	EUR
FLB50.ERC32	1	50	50	30	40-M6	58	
FLB90.ERC32		50	90	41.2	70-M8	72	
FLB110.ERC40		63	110	65.2	86-M8	87	
FLB110.ERC50		78	110	65.2	86-M8	106	