



BUSSOLE PORTAMASCHI - PINZE - TIRANTI E RICAMBI

ADAPTERS - COLLETS -
PULL STUDS AND
ACCESSORIES

1A

BUSSOLE PORTAMASCHI - PINZE - TIRANTI E RICAMBI

ADAPTERS - COLLETS - PULL STUDS AND ACCESSORIES



BUSSOLE FISSE
POSITIVE DRIVE TAP COLLETS



BUSSOLE FISSE A FISSAGGIO MANUALE
POSITIVE DRIVE WITH SET SCREWS

1A

Bussole fisse senza frizione

Quick change adaptors for tapping without safety clutch

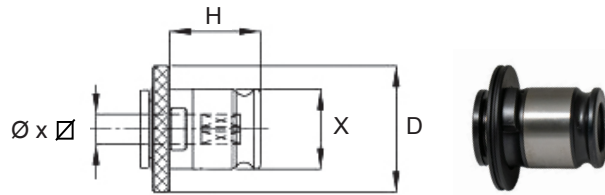
SE DIN

CODICE	TIPO	CAP	Ø X Ø	X	H	D	EUR
SE0-2.5 x 2.1	0	M1 - 1.8	2.5 x 2.1	13	19.5	22	
SE0-2.8 x 2.1		M2 - 2.2 - 2.5 - 4	2.8 x 2.1				
SE0-3.5 x 2.7		M3	3.5 x 2.7				
SE0-4 x 3		M3.5	4 x 3				
SE0-4.5 x 3.4		M4	4.5 x 3.4				
SE0-6 x 4.9		M5 - 6 - 8	6 x 4.9				
SE0-7 x 5.5		M10	7 x 5.5				
SE0-8 x 6.2		M8	8 x 6.2				
SE1-2.5 x 2.1	1	M1 - 1.8	2.5 x 2.1	19	21.5	30	
SE1-2.8 x 2.1		M2 - 2.2 - 2.5 - 4	2.8 x 2.1				
SE1-3.5 x 2.7		M3	3.5 x 2.7				
SE1-4 x 3		M3.5	4 x 3				
SE1-4.5 x 3.4		M4	4.5 x 3.4				
SE1-6 x 4.9		M5 - 6 - 8	6 x 4.9				
SE1-7 x 5.5		M10	7 x 5.5				
SE1-8 x 6.2		M8	8 x 6.2				
SE1-9 x 7		M12	9 x 7				
SE1-10 x 8		M10	10 x 8				
SE1-11 x 9	M14	11 x 9					
SE2-3.5 x 2.7	2	M3	3.5 x 2.7	31	35	48	
SE2-4 x 3		M3.5	4 x 3				
SE2-4.5 x 3.4		M4	4.5 x 3.4				
SE2-6 x 4.9		M5 - 6 - 8	6 x 4.9				
SE2-7 x 5.5		M10	7 x 5.5				
SE2-8 x 6.2		M8	8 x 6.2				
SE2-9 x 7		M12	9 x 7				
SE2-10 x 8		M10	10 x 8				
SE2-11 x 9		M14	11 x 9				
SE2-12 x 9		M16	12 x 9				
SE2-14 x 11		M18	14 x 11				
SE2-16 x 12		M20	16 x 12				
SE2-18 x 14.5		M22 - 24	18 x 14.5				
SE3-9 x 7	3	M12	9 x 7	48	55.5	70	
SE3-10 x 8		M10	10 x 8				
SE3-11 x 9		M14	11 x 9				
SE3-12 x 9		M16	12 x 9				
SE3-14 x 11		M18	14 x 11				
SE3-16 x 12		M20	16 x 12				
SE3-18 x 14.5		M22 - 24	18 x 14.5				
SE3-20 x 16		M27	20 x 16				
SE3-22 x 18		M30	22 x 18				
SE3-25 x 20		M33	25 x 20				
SE3-28 x 22	M36	28 x 22					
SE4-16 x 12	4	M20	16 x 12	60	62.8	90	
SE4-18 x 14.5		M22 - 24	18 x 14.5				
SE4-20 x 16		M27	20 x 16				
SE4-22 x 18		M30	22 x 18				
SE4-25 x 20		M33	25 x 20				
SE4-28 x 22		M36	28 x 22				
SE4-32 x 24		M39 - 42	32 x 24				
SE4-36 x 29	M45 - 48	36 x 29					

Bussole fisse senza frizione

Quick change adaptors for tapping without safety clutch

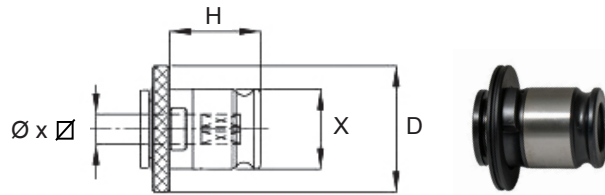
SE ISO

CODICE	TIPO	CAP	Ø x Ø	X	H	D	EUR
SE0-2.24 x 1.8	0	M3	2.24 x 1.8	13	19.5	22	
SE0-2.5 x 2		M2 - M3.5	2.5 x 2				
SE0-2.8 x 2.24		M2.2 - M2.5	2.8 x 2.24				
SE0-3.15 x 2.5		M3 - M4	3.15 x 2.5				
SE0-3.55 x 2.8		M3.5 - M4.5	3.55 x 2.8				
SE0-4 x 3.15		M4 - M5	4 x 3.15				
SE0-4.5 x 3.55		M4.5 - M4.6	4.5 x 3.55				
SE0-5 x 4		M5	5 x 4				
SE0-5.6 x 4.5		M7	5.6 x 4.5				
SE0-6.3 x 5		M6 - M8	6.3 x 5				
SE0-7.1 x 5.6		M7 - M10	7.1 x 5.6				
SE0-8 x 6.3		M8 - M10	8 x 6.3				
SE1-2.24 x 1.8	1	M3	2.24 x 1.8	19	21.5	30	
SE1-2.5 x 2		M2 - M3.5	2.5 x 2				
SE1-2.8 x 2.24		M2.2 - M2.5	2.8 x 2.24				
SE1-3.15 x 2.5		M3 - M4	3.15 x 2.5				
SE1-3.55 x 2.8		M3.5 - M4.5	3.55 x 2.8				
SE1-4 x 3.15		M4 - M5	4 x 3.15				
SE1-4.5 x 3.55		M4.5 - M4.6	4.5 x 3.55				
SE1-5 x 4		M5	5 x 4				
SE1-5.6 x 4.5		M7	5.6 x 4.5				
SE1-6.3 x 5		M6 - M8	6.3 x 5				
SE1-7.1 x 5.6		M7 - M10	7.1 x 5.6				
SE1-8 x 6.3		M8 - M10	8 x 6.3				
SE1-9 x 7.1		M9 - M12	9 x 7.1				
SE1-10 x 8		M10	10 x 8				
SE1-11.2 x 9	M14	11.2 x 9					

Bussole fisse senza frizione

Quick change adaptors for tapping without safety clutch

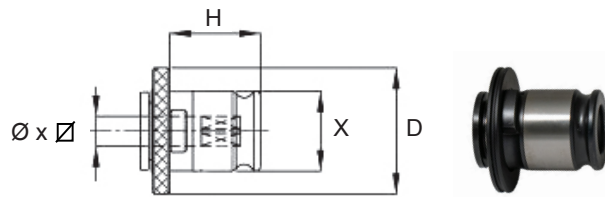
SE ISO

CODICE	TIPO	CAP	MASCHIO	X	H	D	EUR
SE2-6.3 x 5	2	M6 - M8	6.3 x 5	31	35	48	
SE2-7.1 x 5.6		M7 - M10	7.1 x 5.6				
SE2-8 x 6.3		M8 - M10	8 x 6.3				
SE2-9 x 7.1		M9 - M12	9 x 7.1				
SE2-10 x 8		M10	10 x 8				
SE2-11.2 x 9		M14	11.2 x 9				
SE2-12.5 x 10		M16	12.5 x 10				
SE2-14 x 11.2		M18 - M20	14 x 11.2				
SE2-16 x 12.5		M22	16 x 12.5				
SE2-18 x 14		M24	18 x 14				
SE3-11.2 x 9	3	M14	11.2 x 9	48	55.5	70	
SE3-12.5x 10		M16	12.5 x 10				
SE3-14 x 11.2		M18 - M20	14 x 11.2				
SE3-16 x 12.5		M22	16 x 12.5				
SE3-18 x 14		M24	18 x 14				
SE3-20 x 16		M30	20 x 16				
SE3-22.4 x 18		M33	22.4 x 18				
SE3-25 x 20		M33 - M36	25 x 20				
SE3-28 x 22.4		M39 - M42	28 x 22.4				
SE4-16 x 12.5	4	M22	16 x 12.5	60	62.8	90	
SE4-18 x 14		M24	18 x 14				
SE4-20 x 16		M30	20 x 16				
SE4-22.4 x 18		M33	22.4 x 18				
SE4-25 x 20		M33 - M36	25 x 20				
SE4-28 x 22.4		M39 - M42	28 x 22.4				
SE4-31.5 x 25		M45 - M48	31.5 x 25				

Bussole fisse senza frizione

Quick change adaptors for tapping without safety clutch

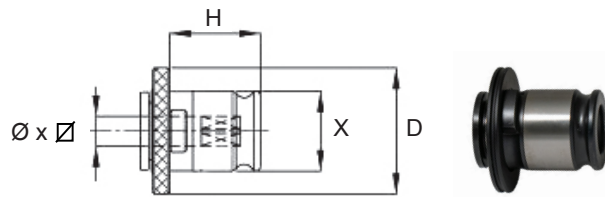
SE JIS

CODICE	TIPO	CAP	MASCHIO	X	H	D	EUR
SE0-3 x 2.5	0	M2	3 x 2.5	13	19.5	22	
SE0-4 x 3.2		M3	4 x 3.2				
SE0-5.5 x 4.5		M5	5.5 x 4.5				
SE0-6 x 4.5		M6	6 x 4.5				
SE0-6.2 x 5		M8	6.2 x 5				
SE0-8 x 6		M8	8 x 6				
SE1-3 x 2.5	1	M2	3 x 2.5	19	21.5	30	
SE1-4 x 3.2		M3	4 x 3.2				
SE1-5.5 x 4.5		M5	5.5 x 4.5				
SE1-6 x 4.5		M6	6 x 4.5				
SE1-6.2 x 5		M8	6.2 x 5				
SE1-8 x 6		M8	8 x 6				
SE1-8.5 x 6.5		M12	8.5 x 6.5				
SE1-9.5 x 7		M13	9.5 x 7				
SE1-10.5 x 8	M14	10.5 x 8					
SE2-6 x 4.5	2	M6	6 x 4.5	31	35	48	
SE2-6.2 x 5		M8	6.2 x 5				
SE2-8 x 6		M8	8 x 6				
SE2-8.5 x 6.5		M12	8.5 x 6.5				
SE2-9.5 x 7		M13	9.5 x 7				
SE2-10.5 x 8		M14	10.5 x 8				
SE2-13 x 10		M17	13 x 10				
SE2-15 x 12		M20	15 x 12				
SE2-17 x 13	M22	17 x 13					
SE3-10.5 x 8	3	M14	10.5 x 8	48	55.5	70	
SE3-13 x 10		M17	13 x 10				
SE3-15 x 12		M20	15 x 12				
SE3-17 x 13		M22	17 x 13				
SE3-19 x 15		M24	19 x 15				
SE3-20 x 15		M27	20 x 15				
SE3-21 x 17		M28	21 x 17				
SE3-23 x 17		M30	23 x 17				
SE3-24 x 19		M32	24 x 19				
SE3-25 x 19		M33	25 x 19				
SE3-26 x 21		M34	26 x 21				
SE3-28 x 21		M36	28 x 21				

Bussole fisse senza frizione in pollici

Quick change adaptors for tapping without safety clutch

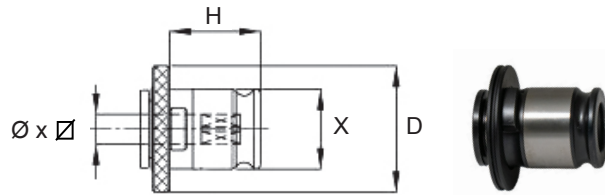
CE INCH

CODICE	TIPO	MASCHIO	Ø x Ø	X	H	D	EUR
CE1-#6	1	#6	.141 x .110	0.75	0.85	1.18	
CE1-#8		#8	.168 x .131				
CE1-#10		#10	.194 x .152				
CE1-#12		#12	.220 x .165				
CE1-1/4		1/4	.255 x .191				
CE1-5/16		5/16	.318 x .238				
CE1-3/8		3/8	.381 x .286				
CE1-7/16		7/16	.323 x .242				
CE1-1/2		1/2	.367 x .275				
CE1-9/16		9/16	.429 x .322				
CE1-3/8SS		3/8SS	.275 x .206				
CE1-1/8SS		1/8SS	.3125 x .234				
CE1-1/8LS		1/8LS	.4375 x .328				
CE2-1/4	2	1/4	.255 x .191	1.22	1.38	1.89	
CE2-5/16		5/16	.318 x .238				
CE2-3/8		3/8	.381 x .286				
CE2-7/16		7/16	.323 x .242				
CE2-1/2		1/2	.367 x .275				
CE2-9/16		9/16	.429 x .322				
CE2-3/8SS		3/8SS	.275 x .206				
CE2-1/8SS		1/8SS	.3125 x .234				
CE2-1/8LS		1/8LS	.4375 x .328				
CE2-5/8		5/8	.480 x .360				
CE2-11/16		11/16	.542 x .406				
CE2-3/4		3/4	.590 x .442				
CE2-13/16		13/16	.652 x .489				
CE2-7/8	7/8	.697 x .523					
CE3-13/16	3	13/16	.652 x .489	1.89	2.18	2.75	
CE3-7/8		7/8	.697 x .523				
CE3-15/16		15/16	.760 x .570				
CE3-1		1	.800 x .600				
CE3-1-1/8		1-1/8	.896 x .672				
CE3-1-1/4		1-1/4	1.021 x .766				
CE3-1-3/8	1-3/8	1.108 x .831					
CE4-1	4	1	.800 x .600	2.36	2.47	3.54	
CE4-1-1/4		1-1/4	1.021 x .766				
CE4-1-1/2		1-1/2	1.233 x .925				
CE4-1-3/4		1-3/4	1.430 x 1.072				
CE4-1-1/8		1-1/8	.896 x .672				
CE4-1-3/8		1-3/8	1.108 x .831				
CE4-1-5/8		1-5/8	1.305 x .979				
CE4-1-7/8		1-7/8	1.519 x 1.139				

Bussole fisse senza frizione in pollici PIPE

Quick change adaptors for tapping without safety clutch PIPE

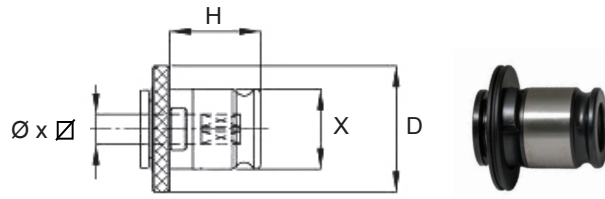

CER INCH

CODICE	TIPO	MASCHIO	Ø x Ø	X	H	D	EUR
CER2-1/4P	2	1/4P	.5625 x .4221	1.22	1.38	1.89	
CER2-3/8P		3/8P	.700 x .531				
CER2-1/2P		1/2P	.6875 x .515				
CER3-3/8P	3	3/8P	.700 x .531	1.89	2.18	2.75	
CER3-1/2P		1/2P	.6875 x .515				
CER3-3/4P		3/4P	.906 x .697				
CER3-1P		1P	1.125 x .843				
CER4-1-1/4P	4	1-1/4P	1.3125 x .984	2.36	2.47	3.54	
CER4-1-1/2P		1-1/2P	1.50 x 1.125				

Bussole fisse senza frizione con passaggio del refrigerante
 Quick change adaptors for tapping without safety clutch with coolant thru

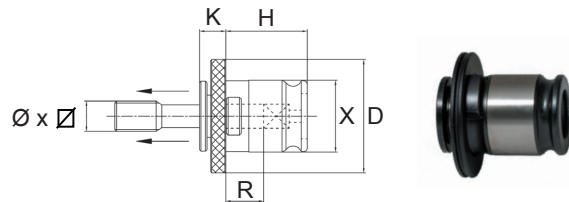
SEC DIN

CODICE	TIPO	CAP	Ø x Ø	X	H	D	K	R	EUR
SEC1-3.5 x 2.7	1	M3	3.5 x 2.7	19	21.5	30	7	10	
SEC1-4 x 3		M3.5	4 x 3						
SEC1-4.5 x 3.4		M4	4.5 x 3.4						
SEC1-6 x 4.9		M5 - 6 - 8	6 x 4.9						
SEC1-7 x 5.5		M10	7 x 5.5						
SEC1-8 x 6.2		M8	8 x 6.2						
SEC1-9 x 7		M12	9 x 7						
SEC1-10 x 8		M10	10 x 8						
SEC1-11 x 9		M14	11 x 9						
SEC2-6 x 4.9	2	M5 - 6 - 8	6 x 4.9	31	35	48	11	19	
SEC2-7 x 5.5		M10	7 x 5.5						
SEC2-8 x 6.2		M8	8 x 6.2						
SEC2-9 x 7		M12	9 x 7						
SEC2-10 x 8		M10	10 x 8						
SEC2-11 x 9		M14	11 x 9						
SEC2-12 x 9		M16	12 x 9						
SEC2-14 x 11		M18	14 x 11						
SEC2-16 x 12		M20	16 x 12						
SEC2-18 x 14.5		M22 - 24	18 x 14.5						
SEC3-11 x 9	3	M14	11 x 9	48	55.5	70	14	30	
SEC3-12 x 9		M16	12 x 9						
SEC3-14 x 11		M18	14 x 11						
SEC3-16 x 12		M20	16 x 12						
SEC3-18 x 14.5		M22 - 24	18 x 14.5						
SEC3-20 x 16		M27	20 x 16						
SEC3-22 x 18		M30	22 x 18						
SEC3-25 x 20		M33	25 x 20						
SEC3-28 x 22		M36	28 x 22						

Bussole fisse senza frizione con passaggio del refrigerante in pollici

Quick change adaptors for tapping without safety clutch with coolant thru

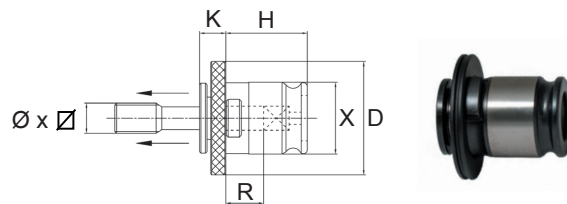
CEC INCH

CODICE	TIPO	MASCHIO	Ø x Ø	X	H	D	K	R	EUR
CEC1-#6	1	#6	.141 x .110	0.75	0.85	1.18	0.27	0.39	
CEC1-#8		#8	.168 x .131						
CEC1-#10		#10	.194 x .152						
CEC1-#12		#12	.220 x .165						
CEC1-1/4		1/4	.255 x .191						
CEC1-5/16		5/16	.318 x .238						
CEC1-3/8		3/8	.381 x .286						
CEC1-7/16		7/16	.323 x .242						
CEC1-1/2		1/2	.367 x .275						
CEC1-9/16		9/16	.429 x .322						
CEC1-3/8SS		3/8SS	.275 x .206						
CEC1-1/8SS		1/8SS	.3125 x .234						
CEC1-1/8LS		1/8LS	.4375 x .328						
CEC2-1/4		2	1/4						.255 x .191
CEC2-5/16	5/16		.318 x .238						
CEC2-3/8	3/8		.381 x .286						
CEC2-7/16	7/16		.323 x .242						
CEC2-1/2	1/2		.367 x .275						
CEC2-9/16	9/16		.429 x .322						
CEC2-3/8SS	3/8SS		.275 x .206						
CEC2-1/8SS	1/8SS		.3125 x .234						
CEC2-1/8LS	1/8LS		.4375 x .328						
CEC2-5/8	5/8		.480 x .360						
CEC2-11/16	11/16		.542 x .406						
CEC2-3/4	3/4		.590 x .442						
CEC2-13/16	13/16		.652 x .489						
CEC2-7/8	7/8		.697 x .523						
CEC3-13/16	3	13/16	.652 x .489	1.89	2.18	2.75	0.55	1.18	
CEC3-7/8		7/8	.697 x .523						
CEC3-15/16		15/16	.760 x .570						
CEC3-1		1	.800 x .600						
CEC3-1-1/8		1-1/8	.896 x .672						
CEC3-1-1/4		1-1/4	1.021 x .766						
CEC3-1-3/8	1-3/8	1.108 x .831							
CEC4-1	4	1	.800 x .600	2.36	2.47	3.54	1.65	1.14	
CEC4-1-1/4		1-1/4	1.021 x .766						
CEC4-1-1/2		1-1/2	1.233 x .925						
CEC4-1-3/4		1-3/4	1.430 x 1.072						
CEC4-1-1/8		1-1/8	.896 x .672						
CEC4-1-3/8		1-3/8	1.108 x .831						
CEC4-1-5/8		1-5/8	1.305 x .979						
CEC4-1-7/8		1-7/8	1.519 x 1.139						

Bussole fisse senza frizione con passaggio del refrigerante in pollici PIPE

Quick change adaptors for tapping without safety clutch with coolant thru PIPE

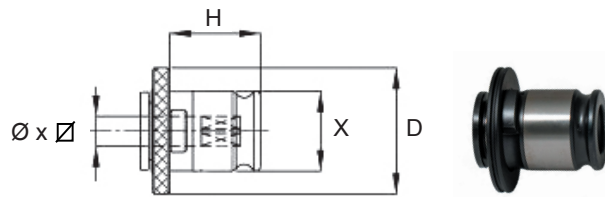
CERC INCH

CODICE	TIPO	MASCHIO	Ø X Ø	X	H	D	EUR
CERC2-1/4P	2	1/4P	.5625 x .4221	1.22	1.38	1.89	
CERC2-3/8P		3/8P	.700 x .531				
CERC2-1/2P		1/2P	.6875 x .515				
CERC3-3/8P	3	3/8P	.700 x .531	1.89	2.18	2.75	
CERC3-1/2P		1/2P	.6875 x .515				
CERC3-3/4P		3/4P	.906 x .697				
CERC3-1P		1P	1.125 x .843				
CERC4-1-1/4P	4	1-1/4P	1.3125 x .984	2.36	2.47	3.54	
CERC4-1-1/2P		1-1/2P	1.50 x 1.125				

Bussole fisse a fissaggio manuale

Positive drive with set screws

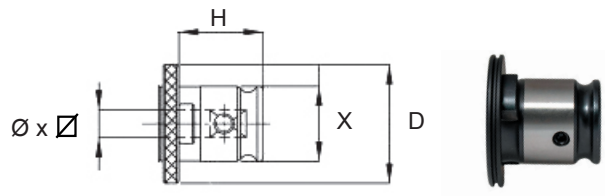
SEK DIN

CODICE	TIPO	CAP	Ø X Ø	X	H	D	EUR
SEK1-12 x 9	1	M16	12 x 9	19	21.5	30	
SEK1-14 x 11		M18	14 x 11				
SEK2-20 x 16	2	M27	20 x 16	31	35	48	
SEK2-22 x 18		M30	22 x 18				
SEK3-32 x 24	3	M39 - 42	32 x 24	48	55.5	70	
SEK3 36 x 29		M45 - 48	36 x 29				
SEK4-40 x 32	4	M52	40 x 32	60	62.8	90	
SEK4-45 x 35		M56 - 60	45 x 35				

Bussole fisse a fissaggio manuale

Positive drive with set screws

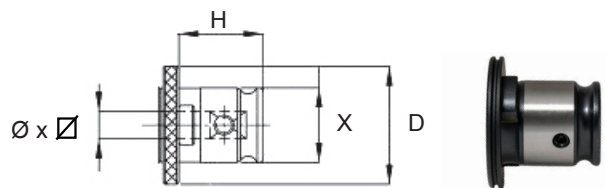
SEK ISO

CODICE	TIPO	CAP	MASCHIO	X	H	D	EUR
SEK0-7.1 x 5.6	0	M7 - M10	7.1 x 5.6	13	19.5	22	
SEK0-8 x 6.3		M8 - M10	8 x 6.3				
SEK1-11.2 x 9	1	M14	11.2 x 9	19	21.5	30	
SEK1-14 x 11.2		M18 - M20	14 x 11.2				
SEK2-18 x 14	2	M24	18 x 14	31	35	48	
SEK2-20 x 16		M30	20 x 16				
SEK3-28 x 22.4	3	M39 - M42	28 x 22.4	48	55.5	70	
SEK3-31.5 x 25		M45 - M48	31.5 x 25				

Bussole fisse a fissaggio manuale in pollici

Inch positive drive with set screws

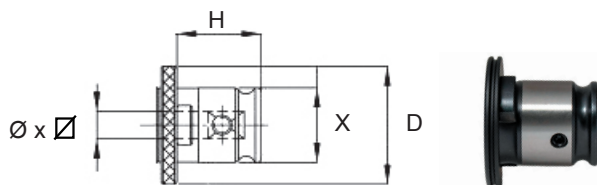
CEK INCH

CODICE	TIPO	MASCHIO	Ø X Ø	X	H	D	EUR
CEK1-5/8	1	5/8	.480 x .360	0.75	0.85	1.18	
CEK1-11/16		11/16	.542 x .406				
CEK1-3/4		3/4	.590 x .442				
CEK2-15/16	2	15/16	.760 x .570	1.22	1.38	1.89	
CEK2-1		1	.800 x .600				
CEK2-1-1/8		1-1/8	.896 x .672				
CEK3-1-1/2	3	1-1/2	1.233 x .925	1.89	2.18	2.75	
CEK3-1-5/8		1-5/8	1.305 x .979				
CEK3-1-3/4		1-3/4	1.430 x 1.072				